

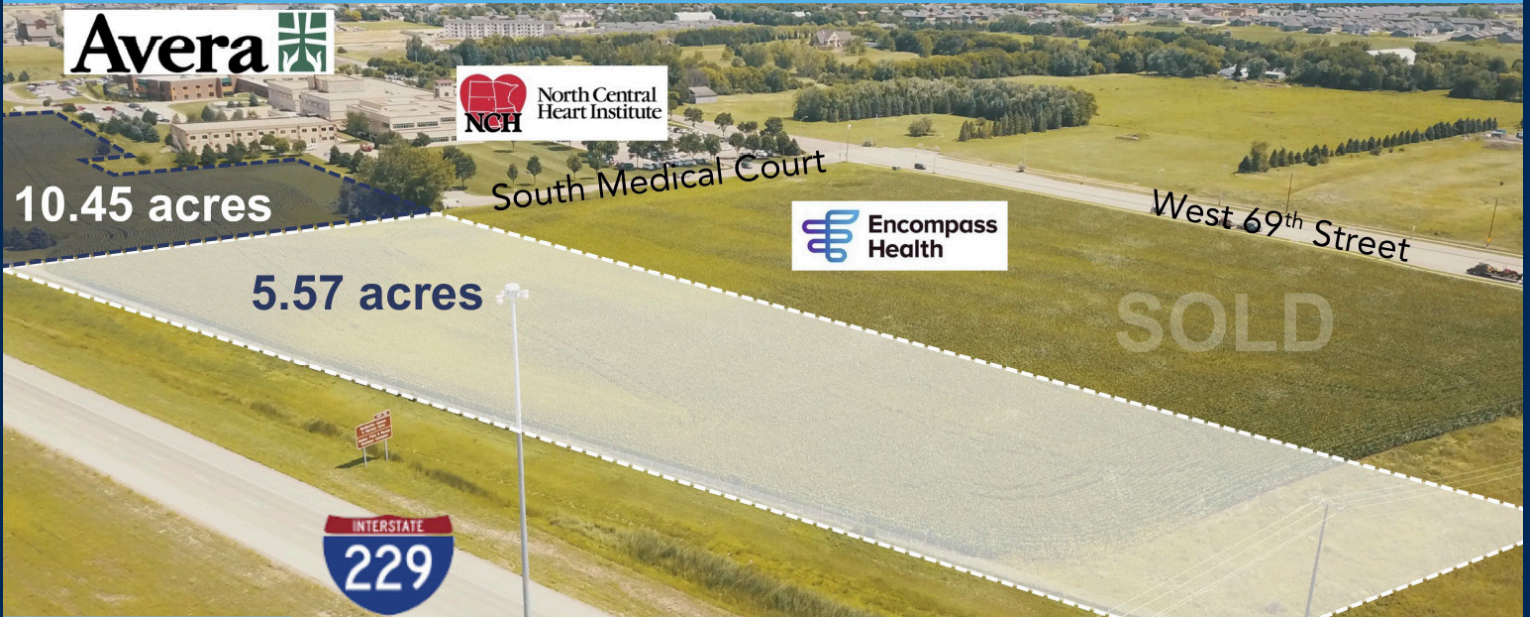

OVERPASS MEDICAL DEVELOPMENT LAND

FANTASTIC I-229 & I-29 DEVELOPMENT LAND

6001 South Medical Court | Sioux Falls, SD 57108



SIZE

Lot 1: 5.57 acres
Lot 2: 10.45 acres



PRICE

\$15.00 psf



LOCATION

Incredible medical / hotel sites with premier interstate visibility.



ZONING

S-1 Institutional



TRAFFIC

Interstate 229: 40,336 vpd
69th Street: 9,900 vpd



AREA TENANTS

Avera Heart Hospital, North Central Heart Institute, Encompass Health, Avera Behavioral Health Center, Homewood Suites, Holiday Inn Express, Sioux Falls Lutheran School, Citi

Information deemed reliable but not guaranteed.



7400 South Bitterroot Place
Sioux Falls, South Dakota 57108



605.376.0127
ryan@tyssdalcommercial.com

AREA MAP



PARCEL MAP

